

-1070.1075

Surface Sample in Au ppb: comma designates multiple samples taken at same location, Staggered values designate samples taken at separate locations but running along the same Northing

Cordex Drill Hole  
 ES 1-12 (2011), ES 13-36 (2013)  
 ES 39-87 (2015)

140'-0.410 g/t Au  
 incl. 20'-1.17 g/t Au

20'-52.2 g/t Ag

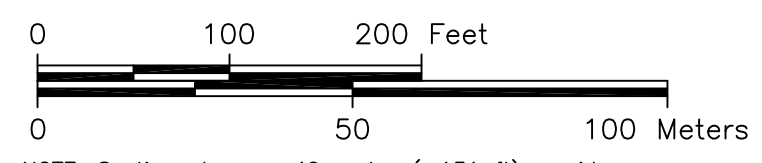

NOTE: Sections have a 40 meter (~131 ft) corridor

CORDEX EXPLORATION CO.  
**Eastside Project**  
 T4N-R39E, M.D.B.&M.  
 Esmeralda County, Nevada

**Section 8590N**

Drawn By: J.A.T.  
 Drawing: 255-ES-XS-2015-NAD83.dwg  
 Layout: XS-100sc-AssaysOnly  
 NOTE: Datum NAD83Z11

Date: Sept. 19, 2015  
 Revised:

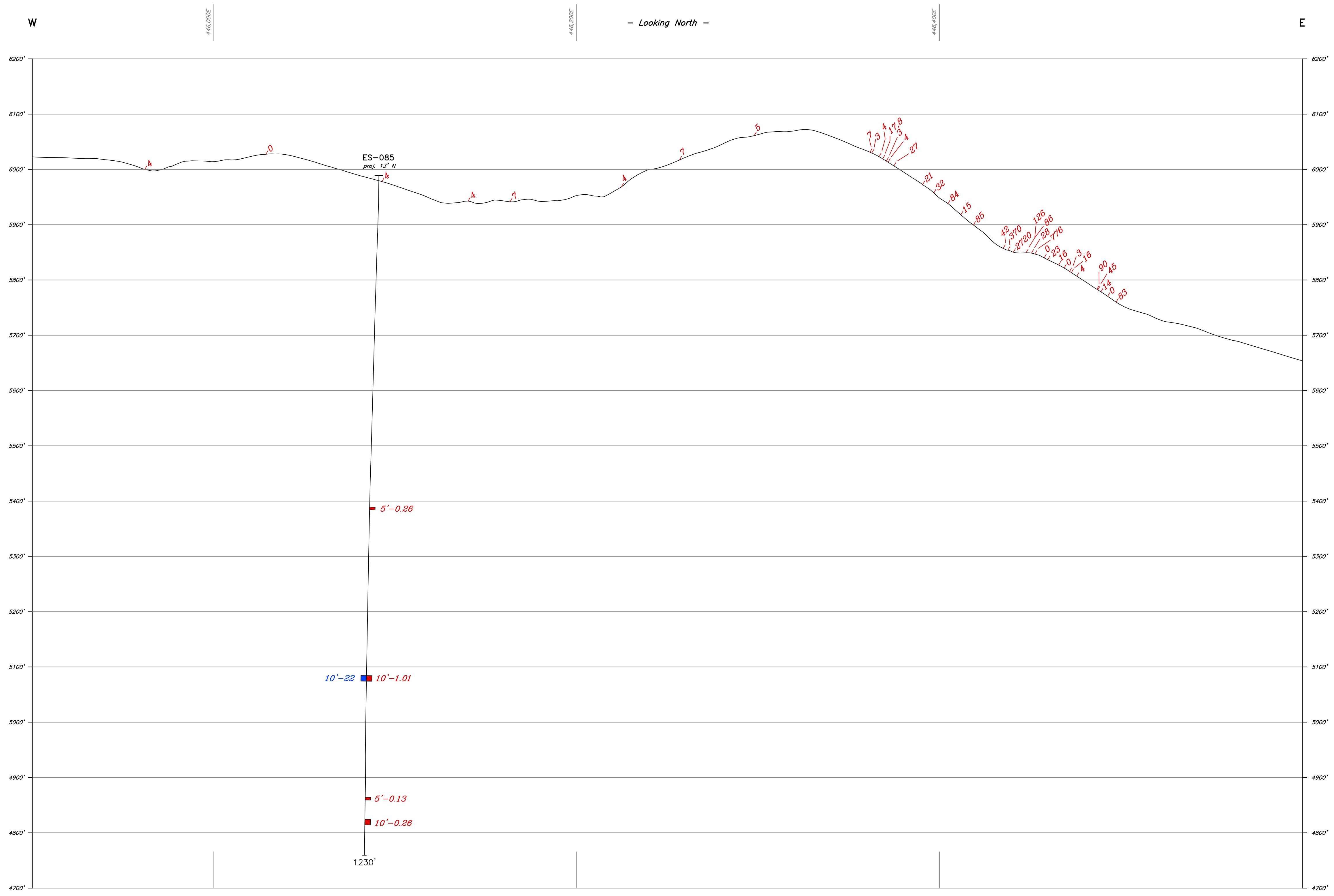

-1070.1075

Surface Sample in Au ppb: comma designates multiple samples taken at same location, Staggered values designate samples taken at separate locations but running along the same Northing

Cordex Drill Hole  
ES 1-12 (2011), ES 13-36 (2013)  
ES 39-87 (2015)

140'-0.410 g/t Au  
incl. 20'-1.17 g/t Au

20'-52.2 g/t Ag

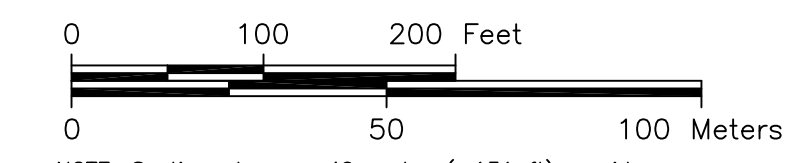

NOTE: Sections have a 40 meter (~131 ft) corridor

CORDEX EXPLORATION CO.  
Eastside Project  
T4N-R39E, M.D.B.&M.  
Esmeralda County, Nevada

Section 8640N

Drawn By: J.A.T.  
Drawing: 255-ES-XS-2015-NAD83.dwg  
Layout: XS-100cc-AssaysOnly  
NOTE: Datum NAD83Z11

Date: Sept. 19, 2015  
Revised:

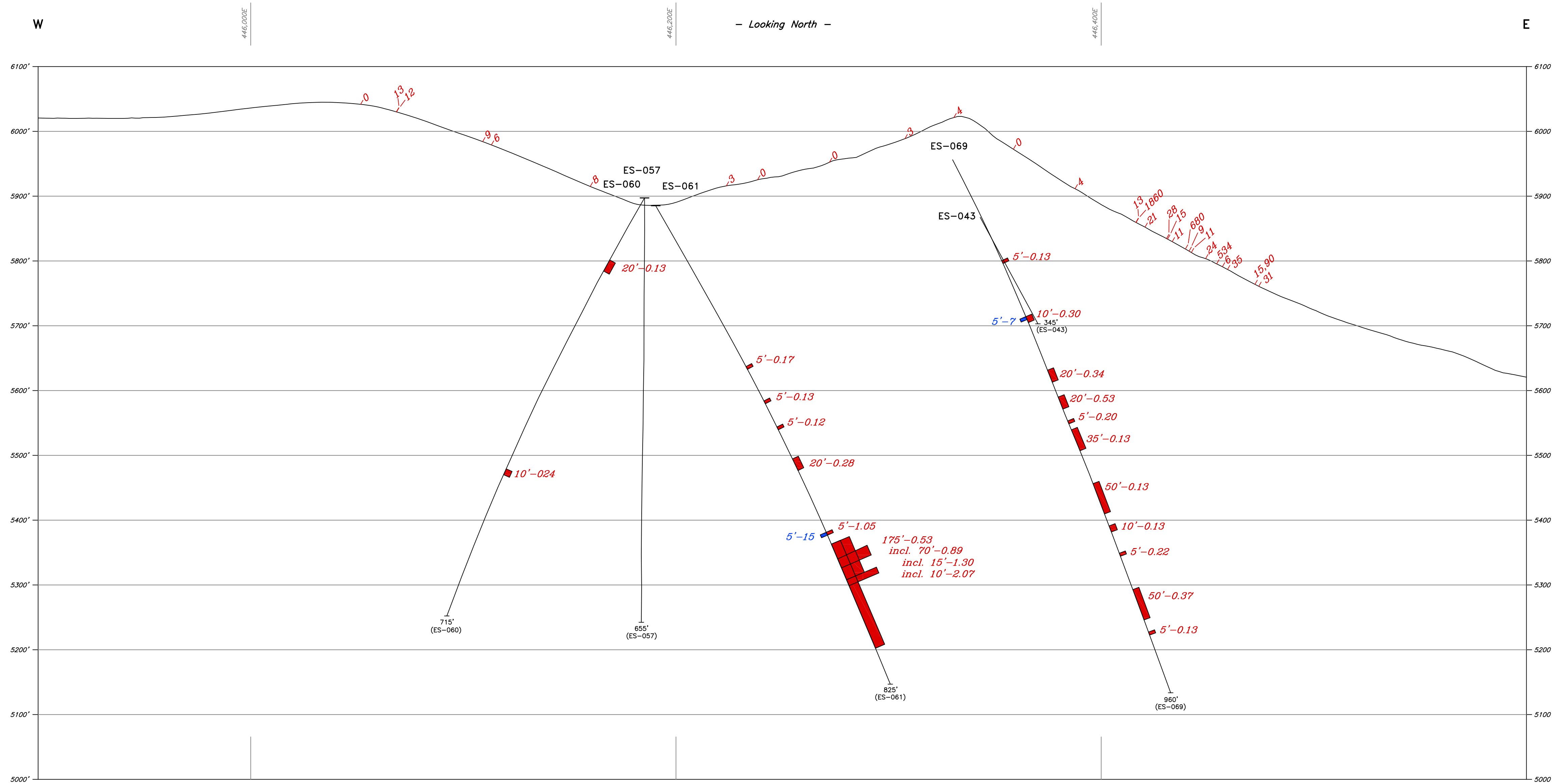

-1070.1075

Surface Sample in Au ppb: comma designates multiple samples taken at same location, Staggered values designate samples taken at separate locations but running along the same Northing

Cordex Drill Hole  
ES 1-12 (2011), ES 13-36 (2013)  
ES 39-87 (2015)

140'-0.410 g/t Au  
incl. 20'-1.17 g/t Au

20'-52.2 g/t Ag

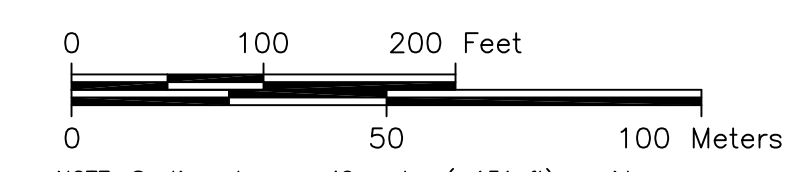

NOTE: Sections have a 40 meter (~131 ft) corridor

<i>CORDEX EXPLORATION CO.</i>	
<b>Eastside Project</b>	
T4N-R39E, M.D.B.&M. Esmeralda County, Nevada	
<b>Section 8700N</b>	
Drawn By: J.A.T. Drawing: 255-ES-XS-2015-NAD83.dwg Layout: XS-100sc-AssaysOnly NOTE: Datum NAD83Z11	Date: Sept. 19, 2015 Revised:

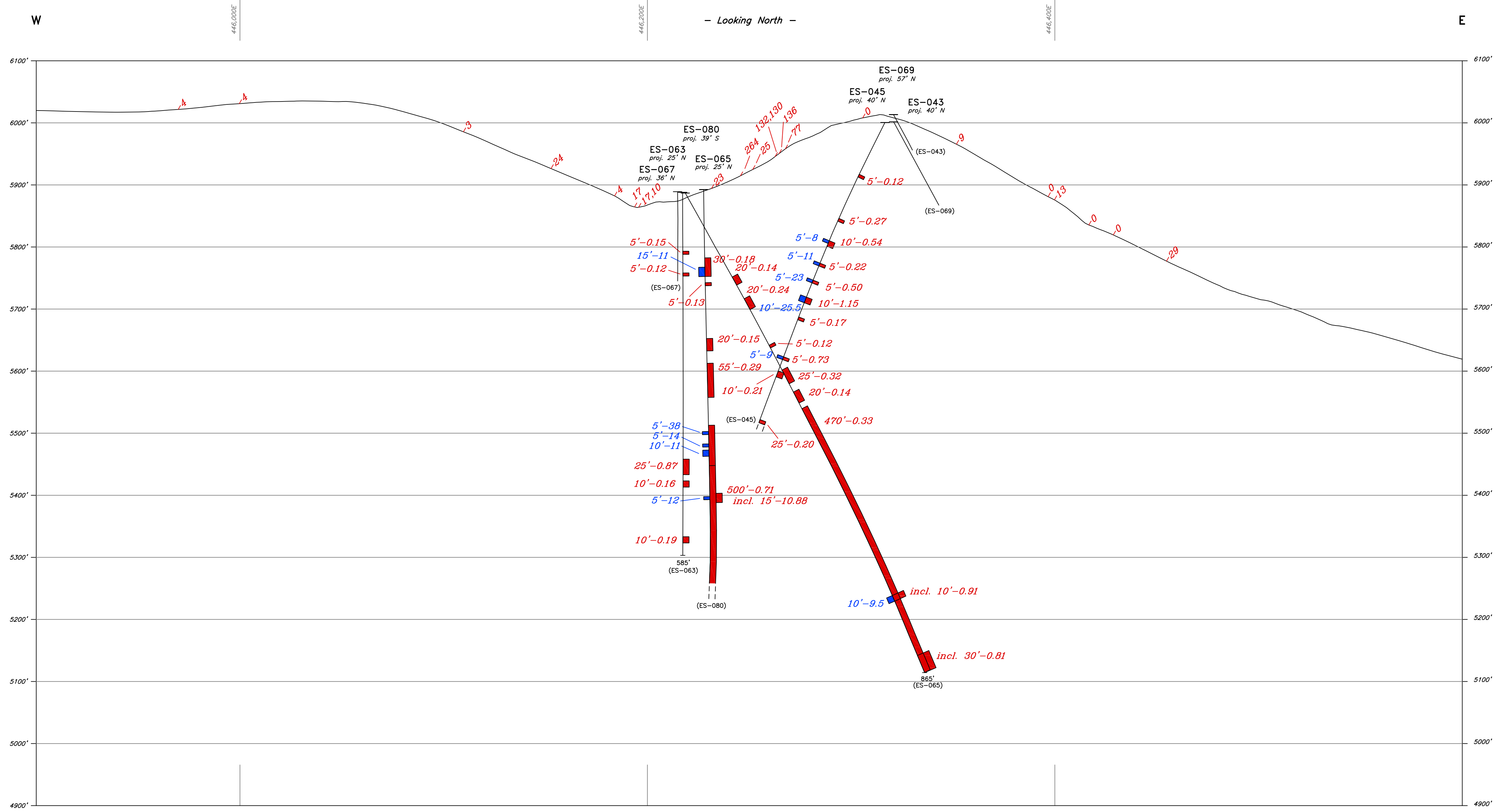

-1070.1075

Surface Sample in Au ppb: comma designates multiple samples taken at same location. Staggered values designate samples taken at separate locations but running along the same Northing

Cordex Drill Hole  
ES 1-12 (2011), ES 13-36 (2013)  
ES 39-87 (2015)

140'-0.410 g/t Au  
incl. 20'-1.17 g/t Au

20'-52.2 g/t Ag

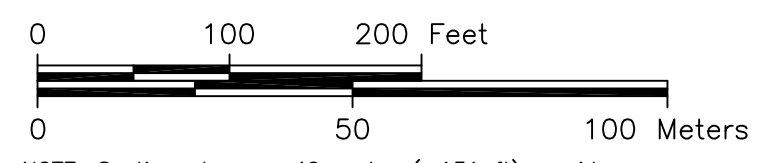

NOTE: Sections have a 40 meter (~131 ft) corridor

**CORDEX EXPLORATION CO.**

**Eastside Project**

T4N-R39E, M.D.B.&M.  
Esmeralda County, Nevada

**Section 8740N**

Drawn By: J.A.T. Drawing: 255-ES-XS-2015-NAD83.dwg Layout: XS-100ac-AssaysOnly NOTE: Datum NAD83Z11	Date: Sept. 19, 2015 Revised:
--	----------------------------------

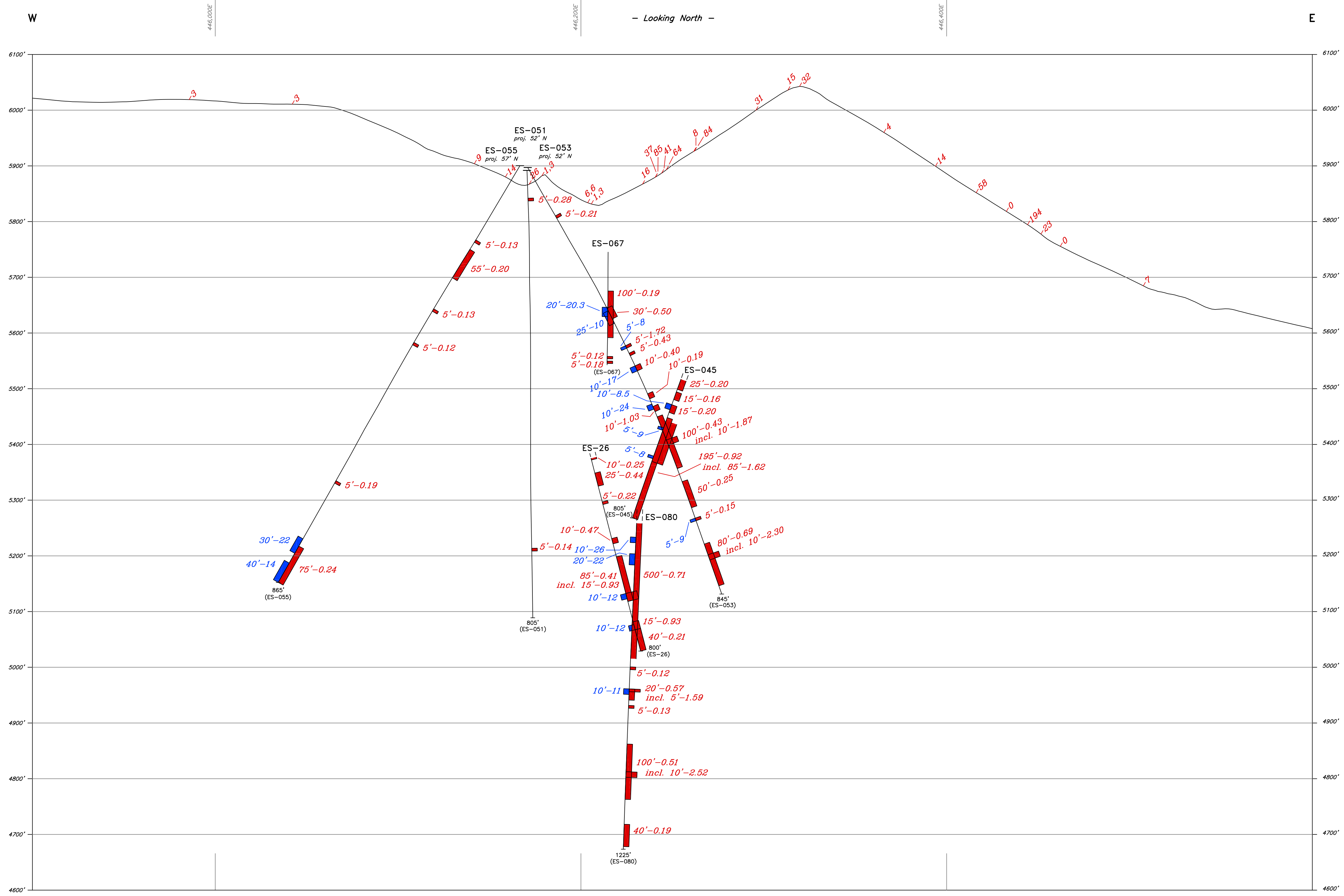

*-1070.1076*

Surface Sample in Au ppb: comma designates multiple samples taken at same location, Staggered values designate samples taken at separate locations but running along the same Northing

Cordex Drill Hole  
ES 1-12 (2011), ES 13-36 (2013)  
ES 39-87 (2015)

*140'-0.410 g/t Au  
incl. 20'-1.17 g/t Au*

*20'-52.2 g/t Ag*

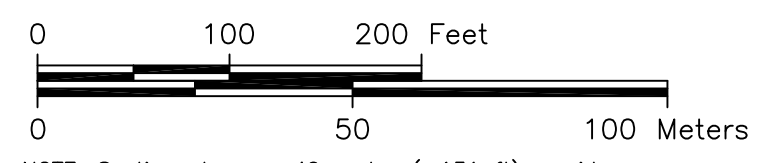

NOTE: Sections have a 40 meter (~131 ft) corridor

**CORDEX EXPLORATION CO.**

**Eastside Project**

T4N-R39E, M.D.B.&M.  
Esmeralda County, Nevada

**Section 8780N**

Drawn By: J.A.T. Drawing: 255-ES-XS-2015-NAD83.dwg Layout: XS-100cc-AssaysOnly NOTE: Datum NAD83Z11	Date: Sept. 19, 2015 Revised:
--	----------------------------------

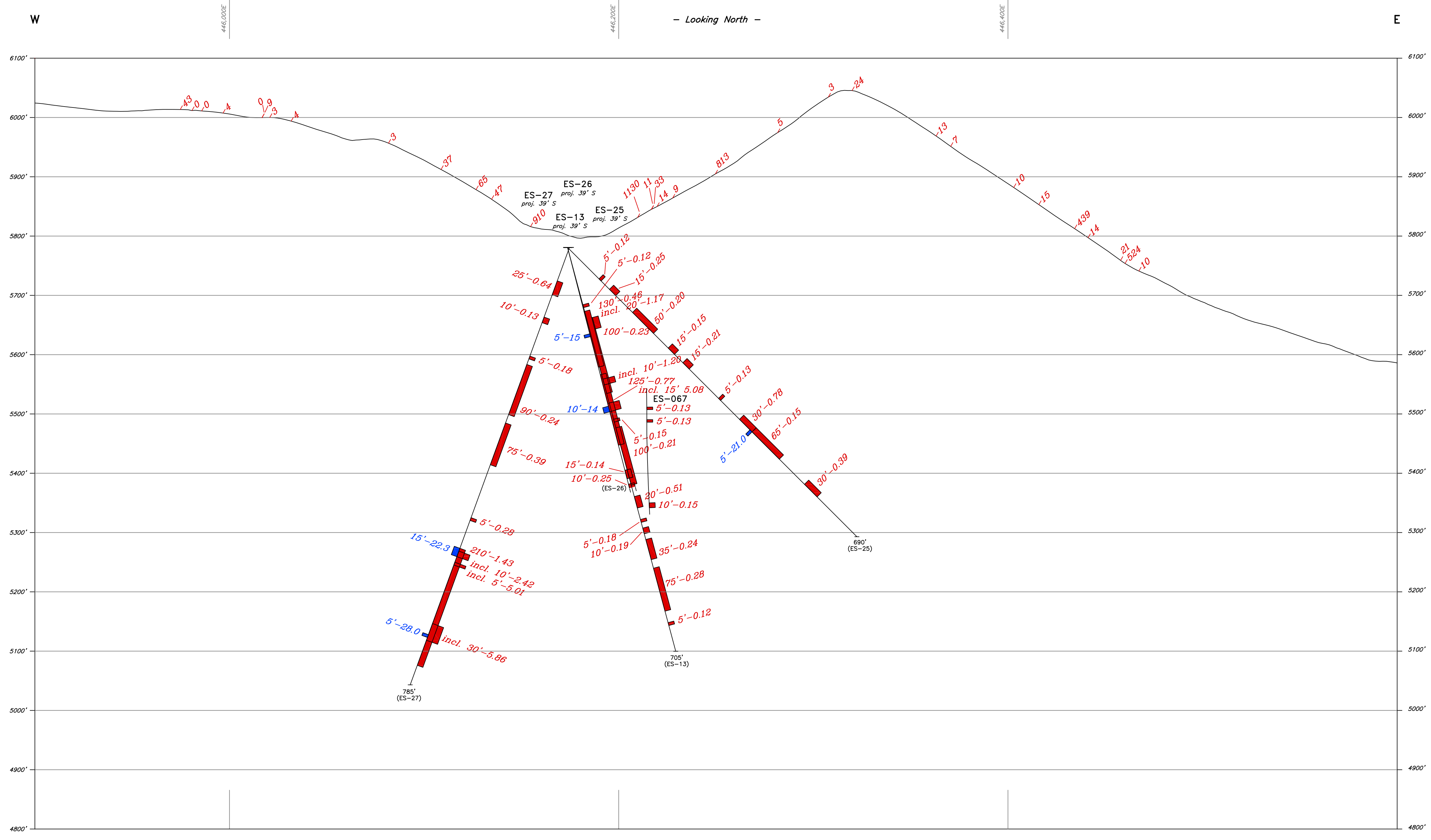

-1070.1075

Surface Sample in Au ppb: comma designates multiple samples taken at same location, Staggered values designate samples taken at separate locations but running along the same Northing

Cordex Drill Hole  
 ES 1-12 (2011), ES 13-36 (2013)  
 ES 39-87 (2015)

140'-0.410 g/t Au  
 incl. 20'-1.17 g/t Au

20'-52.2 g/t Ag

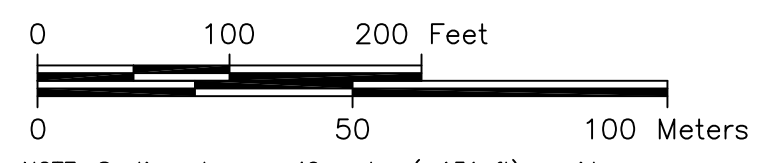

NOTE: Sections have a 40 meter (~131 ft) corridor

**CORDEX EXPLORATION CO.**

**Eastside Project**

T4N-R39E, M.D.B.&M.  
 Esmeralda County, Nevada

**Section 8820N**

Drawn By: J.A.T. Drawing: 255-ES-XS-2015-NAD83.dwg Layout: XS-100cc-AssaysOnly NOTE: Datum NAD83Z11	Date: Sept. 19, 2015 Revised:
--	----------------------------------

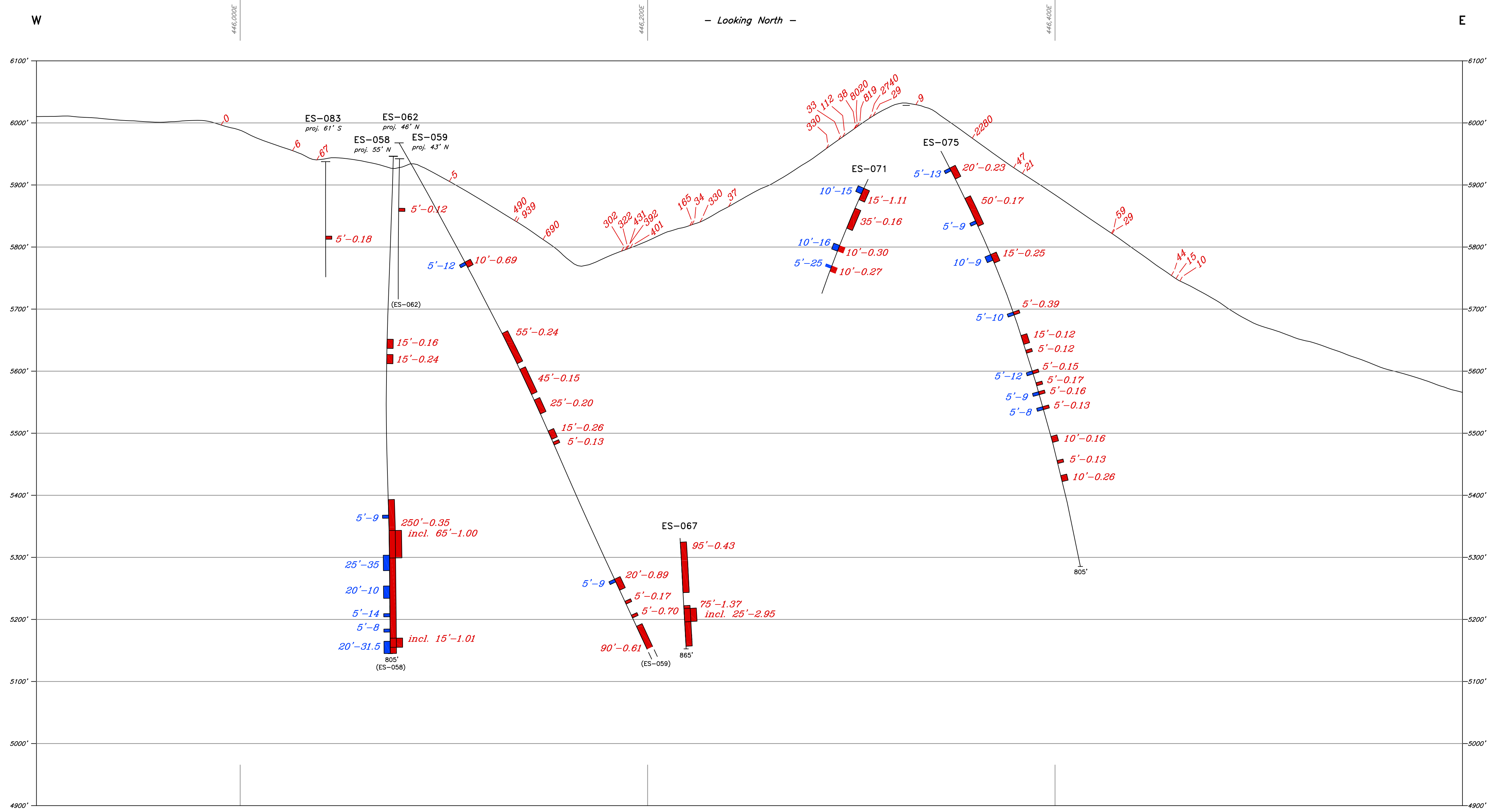

-1070,1075

Surface Sample in Au ppb: comma designates multiple samples taken at same location. Staggered values designate samples taken at separate locations but running along the same Northing

Cordex Drill Hole  
ES 1-12 (2011), ES 13-36 (2013)  
ES 39-87 (2015)

140'-0.410 g/t Au  
incl. 20'-1.17 g/t Au

20'-52.2 g/t Ag

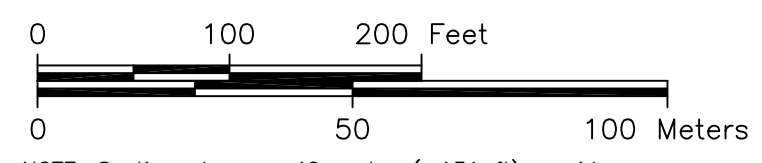

NOTE: Sections have a 40 meter (~131 ft) corridor

**CORDEX EXPLORATION CO.**

**Eastside Project**

T4N-R39E, M.D.B.&M.  
Esmeralda County, Nevada

**Section 8860N**

Drawn By: J.A.T. Drawing: 255-ES-2015-NAD83.dwg Layout: XS-100c-AssaysOnly NOTE: Datum NAD83Z11	Date: Sept. 19, 2015 Revised:
--	----------------------------------

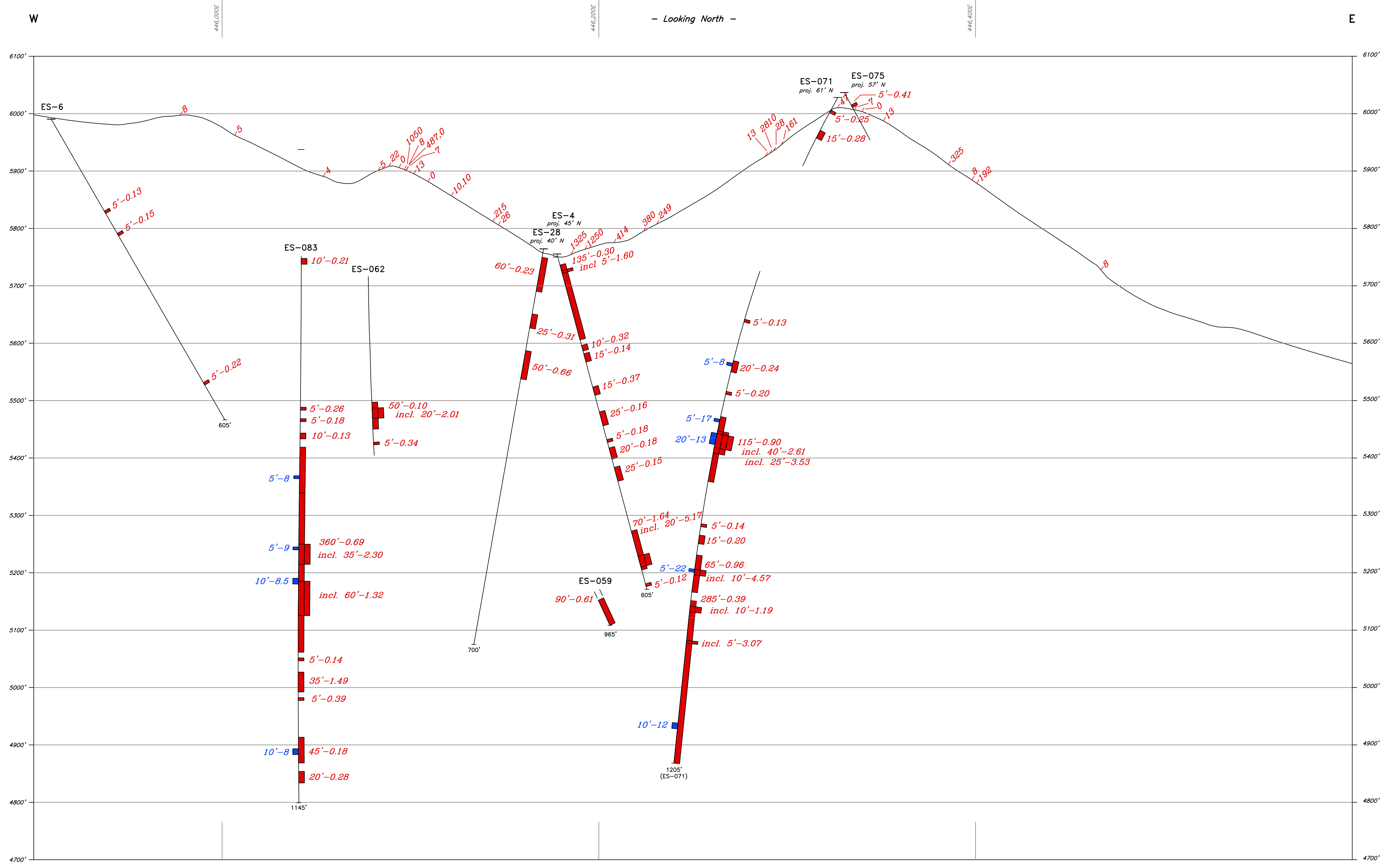

Surface Sample in Au ppb: comma designates multiple samples taken at same location, Staggered values designate samples taken at separate locations but running along the same Northing

Cordex Drill Hole  
ES 1-12 (2011), ES 13-36 (2013)  
ES 39-87 (2015)

140'-0.410 g/t Au  
incl. 20'-1.17 g/t Au

20'-52.2 g/t Ag

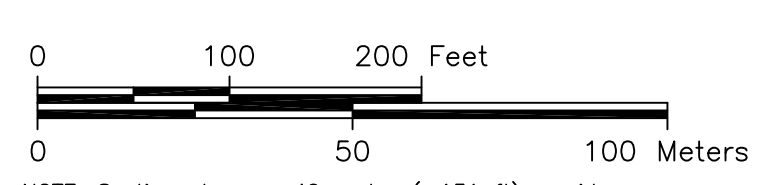

NOTE: Sections have a 40 meter (~131 ft) corridor

**CORDEX EXPLORATION CO.**

**Eastside Project**  
T4N-R39E, M.D.B.&M.  
Esmeralda County, Nevada

**Section 8900N**

Drawn By: J.A.T.  
Drawing: 255-ES-XS-2015-NAD83.dwg  
Layout: XS-100sc-AssaysOnly  
NOTE: Datum NAD83Z11

Date: Sept. 19, 2015  
Revised:



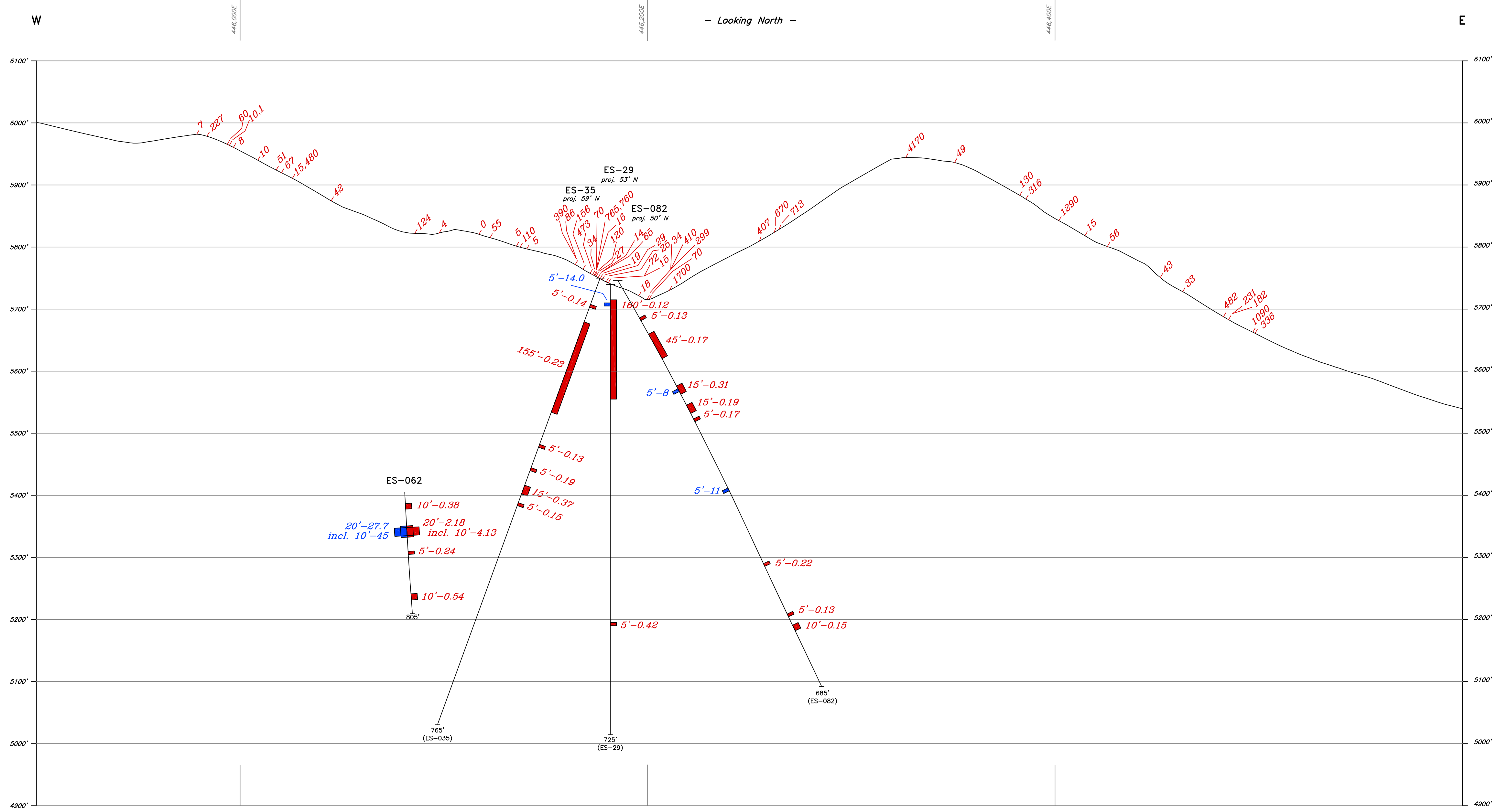

Surface Sample in Au ppb: comma designates multiple samples taken at same location. Staggered values designate samples taken at separate locations but running along the same Northing

Cordex Drill Hole  
ES 1-12 (2011), ES 13-36 (2013)  
ES 39-87 (2015)

140'-0.410 g/t Au  
incl. 20'-1.17 g/t Au

20'-52.2 g/t Ag

0 100 200 Feet  
0 50 100 Meters

NOTE: Sections have a 40 meter (~131 ft) corridor

**CORDEX EXPLORATION CO.**

**Eastside Project**  
T4N-R39E, M.D.B.&M.  
Esmeralda County, Nevada

**Section 8940N**

Drawn By: J.A.T.  
Drawing: 255-ES-XS-2015-NAD83.dwg  
Layout: XS-100cc-AssaysOnly  
NOTE: Datum NAD83Z11

Date: Sept. 19, 2015  
Revised:

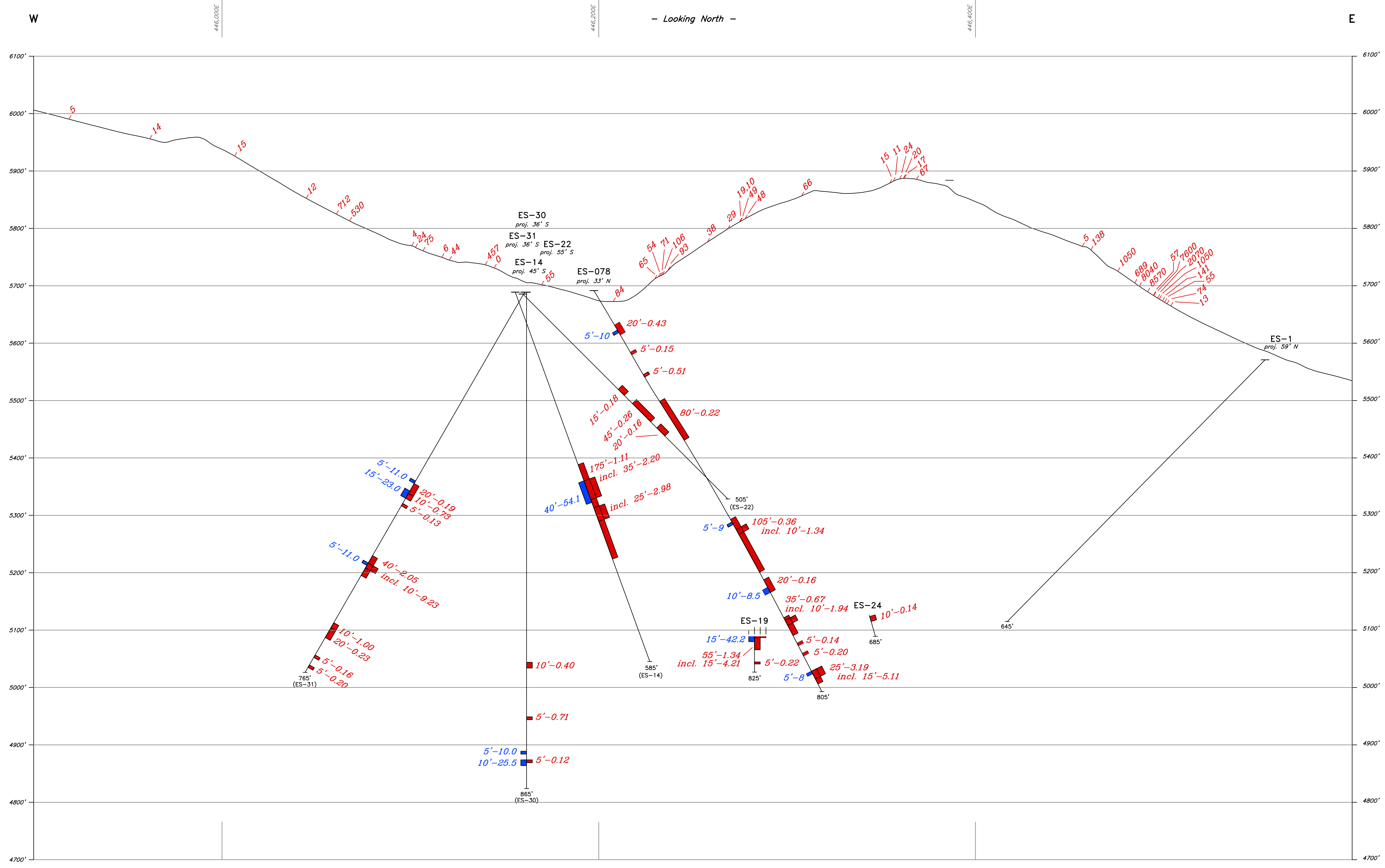

-1070.1075

Surface Sample in Au ppb: comma designates multiple samples taken at same location. Staggered values designate samples taken at separate locations but running along the same Northing

Cordex Drill Hole  
 ES 1-12 (2011), ES 13-36 (2013)  
 ES 39-87 (2015)

20'-52.2 g/t Ag  
 140'-0.410 g/t Au  
 incl. 20'-1.17 g/t Au

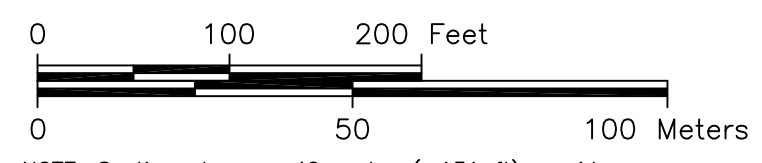

NOTE: Sections have a 40 meter (~131 ft) corridor

**CORDEX EXPLORATION CO.**  
**Eastside Project**  
 T4N-R39E, M.D.B.&M.  
 Esmeralda County, Nevada

**Section 8980N**

Drawn By: J.A.T.  
 Drawing: 255-ES-2015-NAD83.dwg  
 Layout: XS-100cc-AssaysOnly  
 NOTE: Datum NAD83Z11

Date: Sept. 19, 2015  
 Revised:

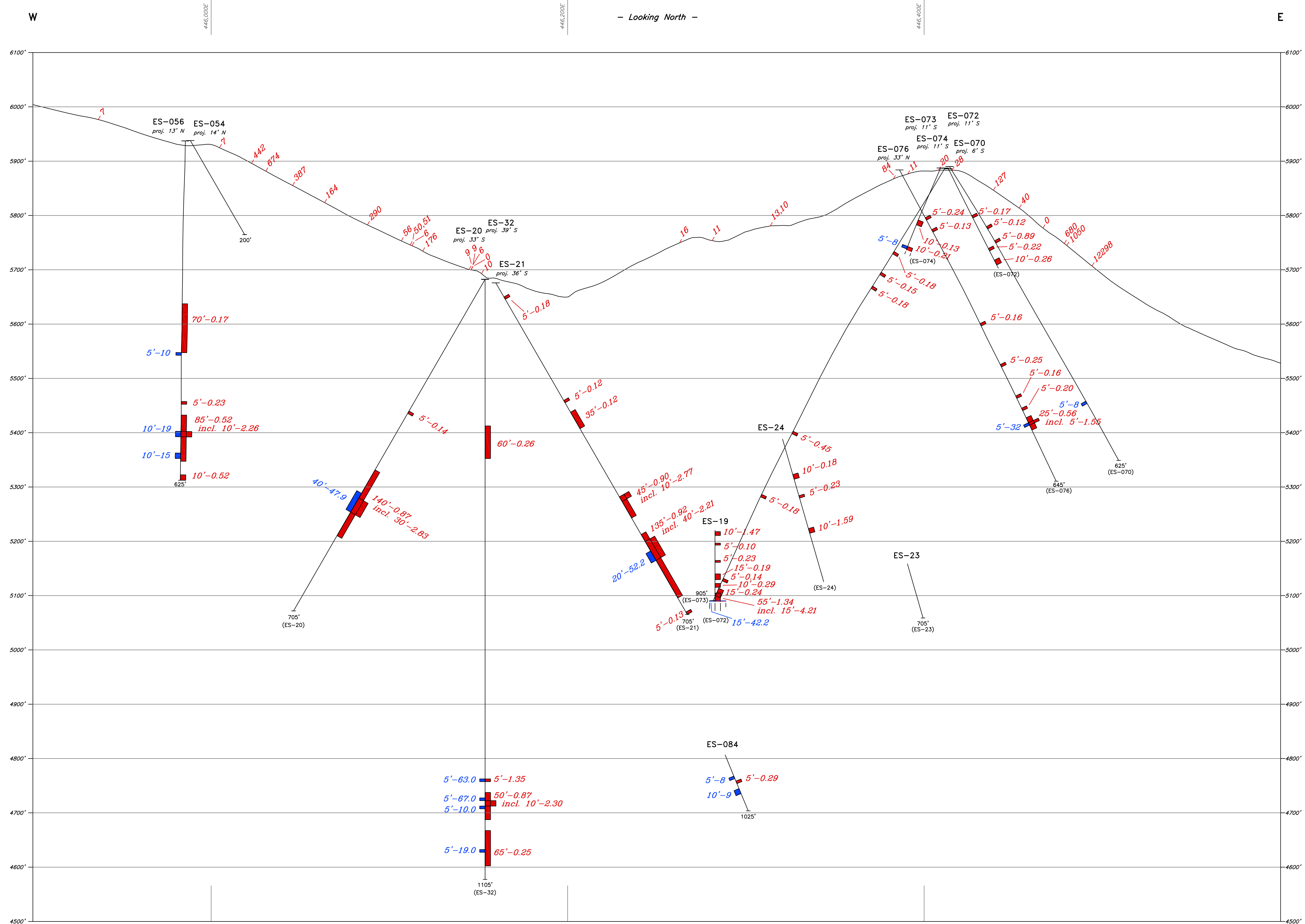

-1070,1070

Surface Sample in Au ppb; comma designates multiple samples taken at same location. Staggered values designate samples taken at separate locations but running along the same Northing

CordeX Drill Hole  
 ES 1-12 (2011), ES 13-36 (2013)  
 ES 39-87 (2015)

140'-0.410 g/t Au  
 incl. 20'-1.17 g/t Au

20'-52.2 g/t Ag

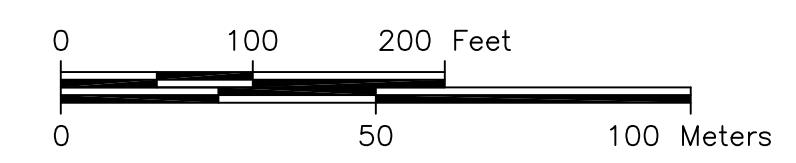

NOTE: Sections have a 40 meter (~131 ft) corridor

<b>CORDEX EXPLORATION CO.</b>	
<b>Eastside Project</b>	
T4N-R39E, M.D.B.&M. Esmeralda County, Nevada	
<b>Section 9020N</b>	
Drawn By: J.A.T. Drawing: 25-ES-XS-2015-NA083.dwg Layout: XS-10Sec-AssaysOnly NOTE: Datum NAD83211	Date: Sept. 21, 2015 Revised:

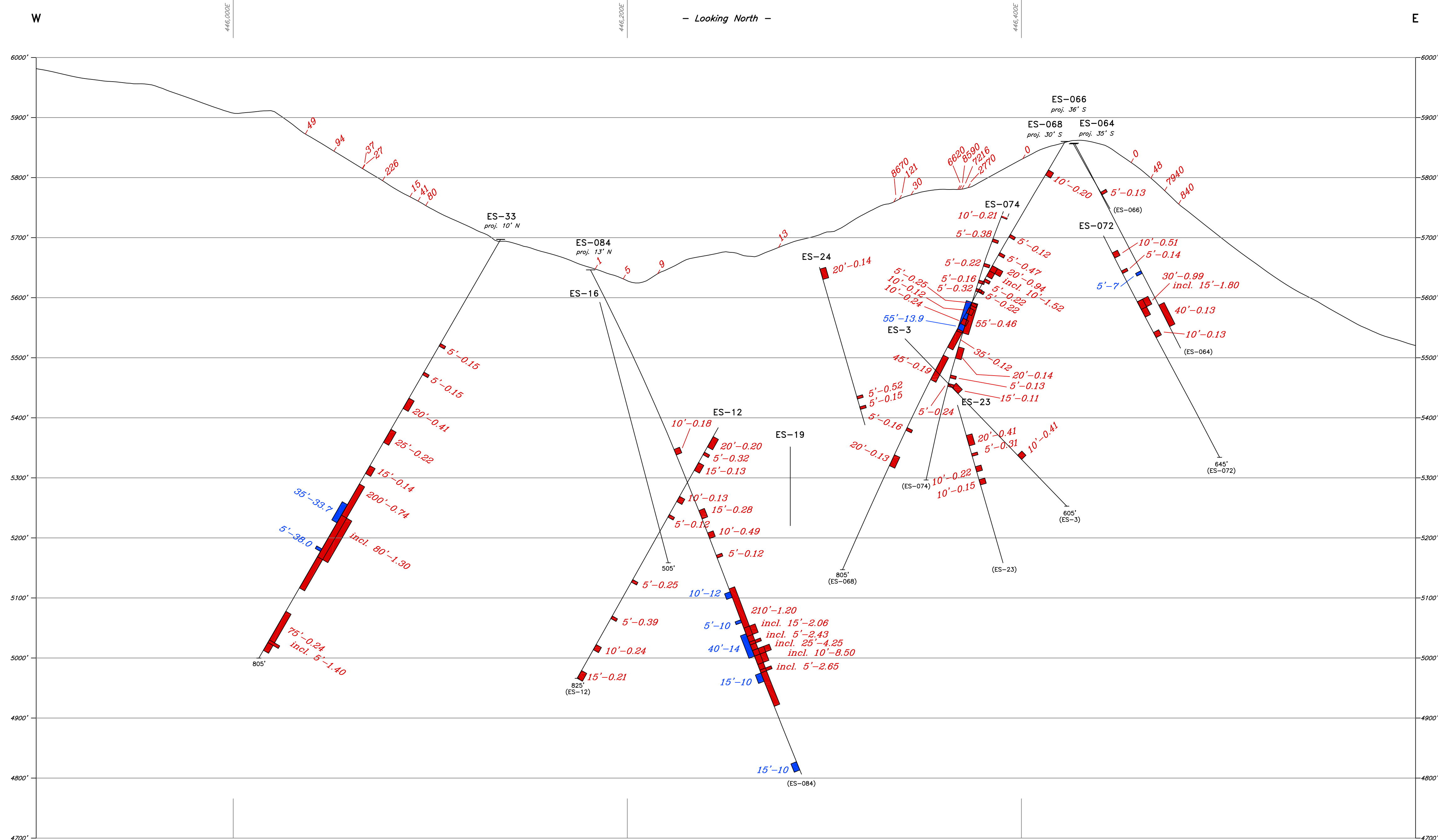

Surface Sample in Au ppb; comma designates multiple samples taken at same location. Staggered values designate samples taken at separate locations but running along the same Northing

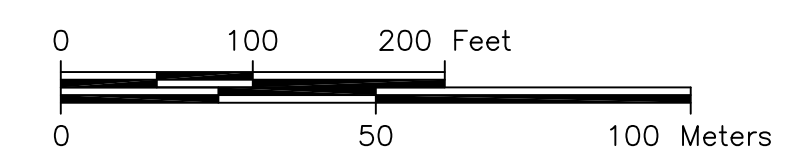
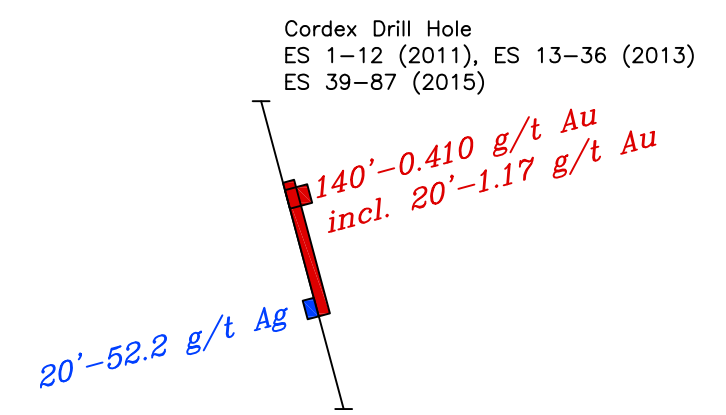

**CORDEX EXPLORATION CO.**

**Eastside Project**  
 T4N-R39E, M.D.B.&M.  
 Esmeralda County, Nevada

**Section 9060N**

Drawn By: J.A.T. Drawing: 25-ES-XS-2015-NA083.dwg Layout: XS-100ss-AssaysOnly NOTE: Datum NAD83Z11	Date: Sept. 21, 2015 Revised:
---	----------------------------------

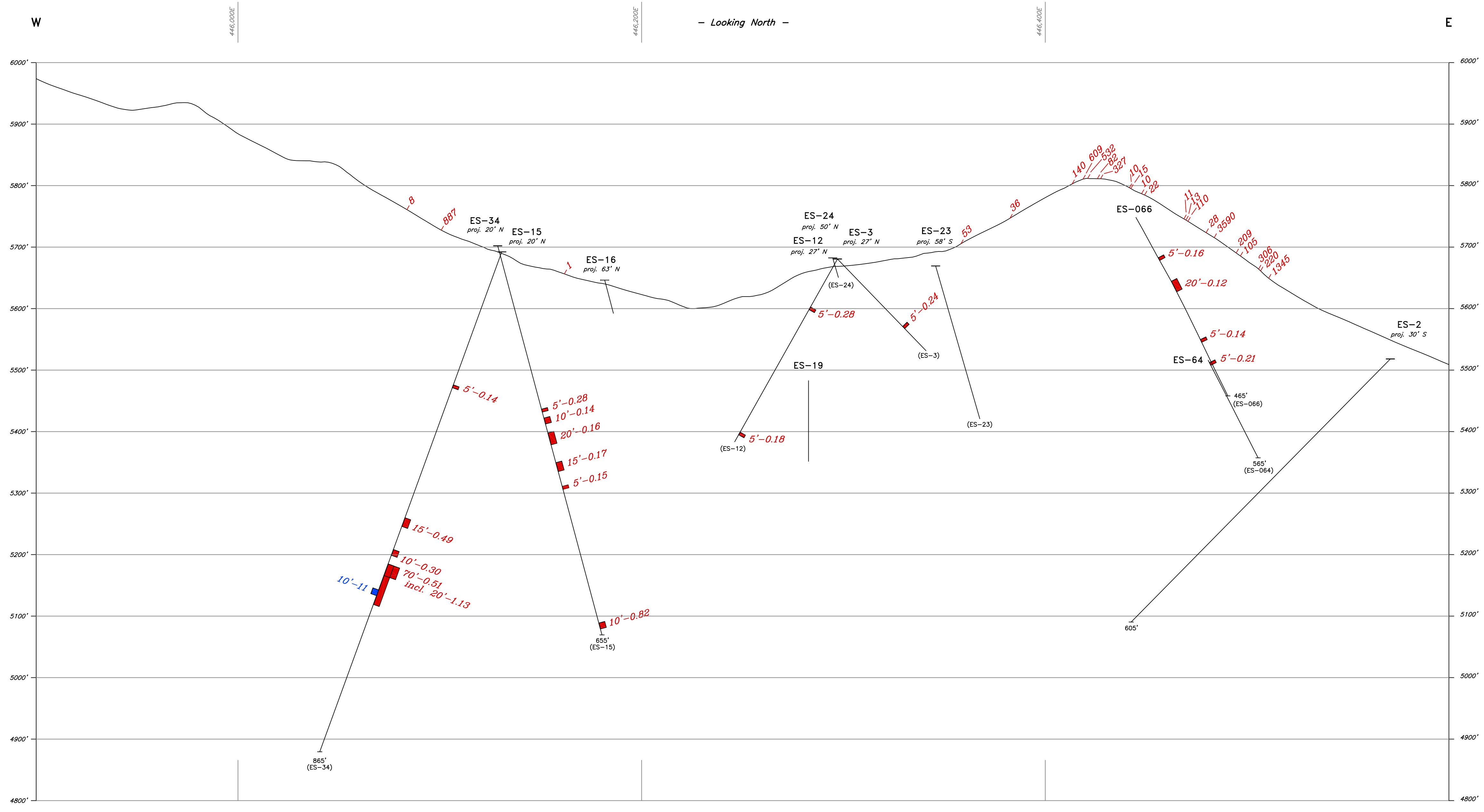

-1070.1076

Surface Sample in Au ppb: comma designates multiple samples taken at same location. Staggered values designate samples taken at separate locations but running along the same Northing

Cordex Drill Hole  
 ES 1-12 (2011), ES 13-36 (2013)  
 ES 39-87 (2015)

20'-52.2 g/t Ag  
 140'-0.410 g/t Au  
 incl. 20'-1.17 g/t Au

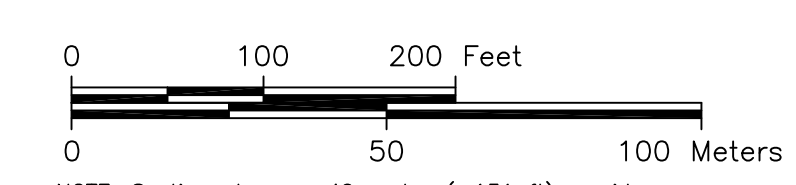

NOTE: Sections have a 40 meter (~131 ft) corridor

**CORDEX EXPLORATION CO.**

**Eastside Project**  
 T4N-R39E, M.D.B.&M.  
 Esmeralda County, Nevada

**Section 9100N**

Drawn By: J.A.T. Drawing: 255-ES-2015-NAD83.dwg Layout: XS-100sc-AssaysOnly NOTE: Datum NAD83Z11	Date: Sept. 19, 2015 Revised:
---	----------------------------------

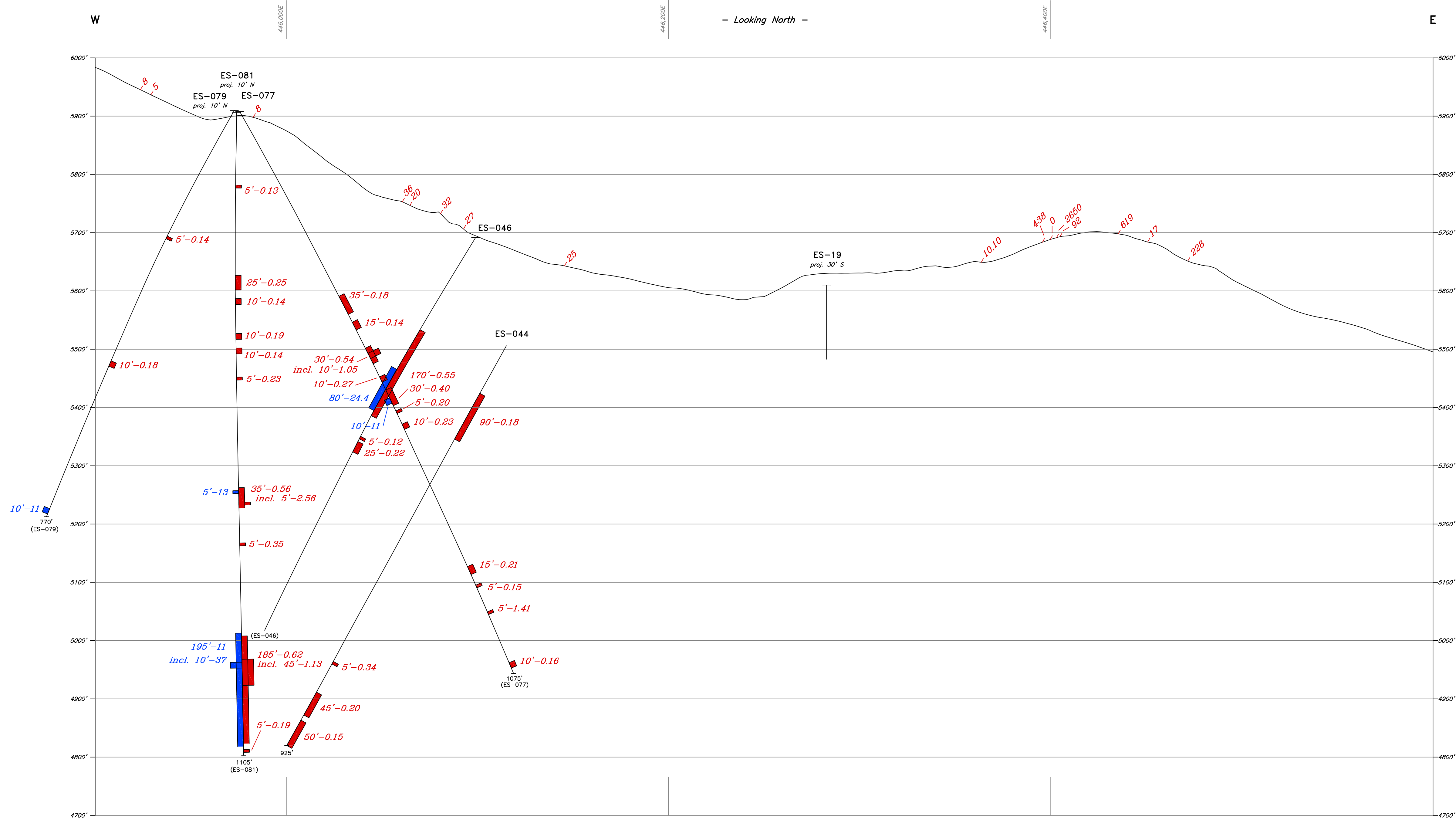

-1070.1075

Surface Sample in Au ppb: comma designates multiple samples taken at same location. Staggered values designate samples taken at separate locations but running along the same Northing

Cordex Drill Hole  
 ES 1-12 (2011), ES 13-36 (2013)  
 ES 39-87 (2015)

140'-0.410 g/t Au  
 incl. 20'-1.17 g/t Au

20'-52.2 g/t Ag

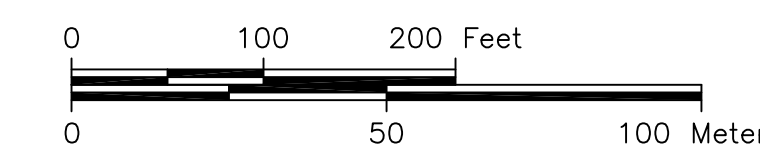

NOTE: Sections have a 40 meter (~131 ft) corridor

<i>CORDEX EXPLORATION CO.</i>	
<b>Eastside Project</b>	
T4N-R39E, M.D.B.&M. Esmeralda County, Nevada	
<b>Section 9140N</b>	
Drawn By: J.A.T. Drawing: 255-ES-XS-2015-NAD83.dwg Layout: XS-100cc-AssaysOnly NOTE: Datum NAD83Z11	Date: Sept. 19, 2015 Revised:

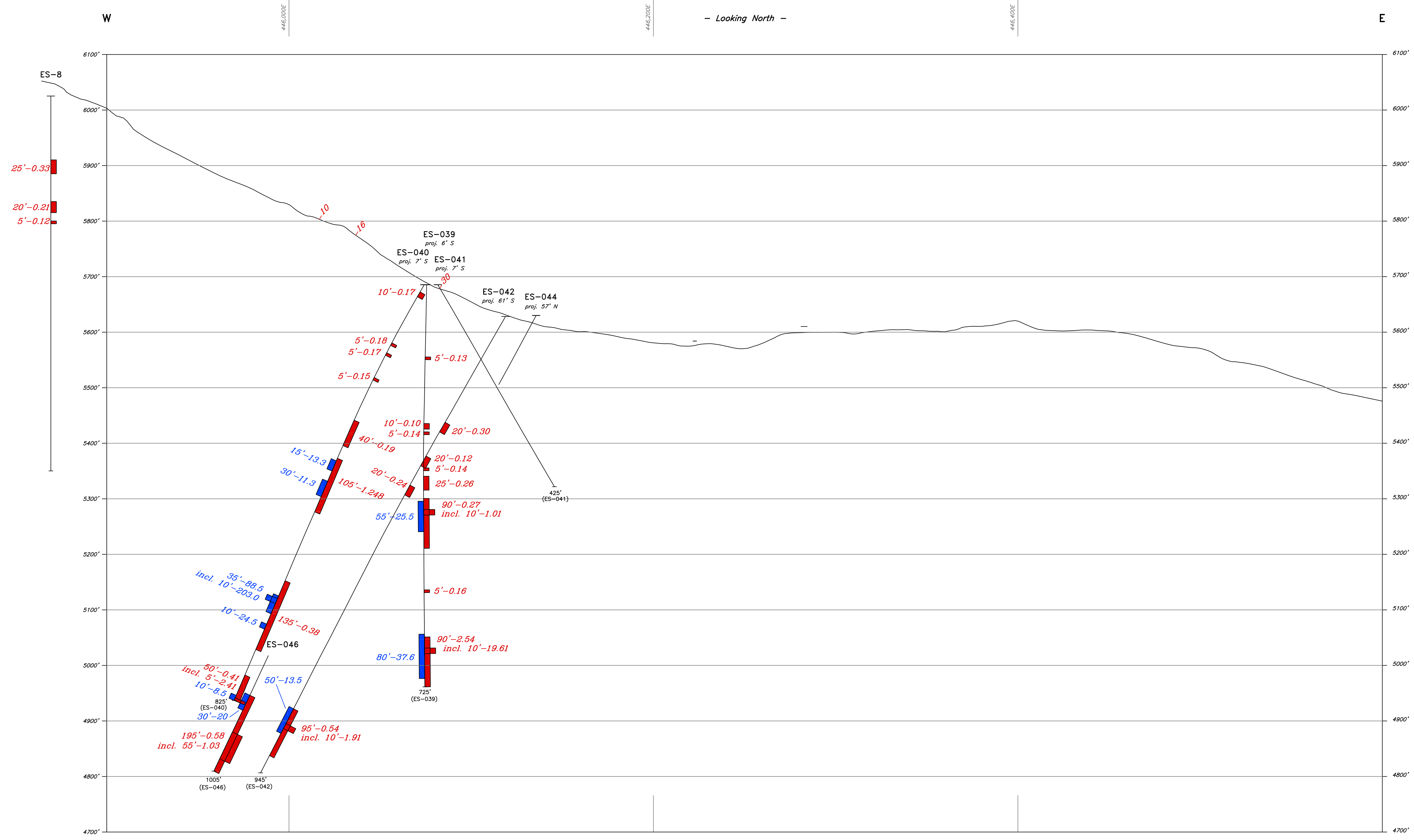

-1070.1075

Surface Sample in Au ppb: comma designates multiple samples taken at same location. Staggered values designate samples taken at separate locations but running along the same Northing

Cordex Drill Hole  
ES 1-12 (2011), ES 13-36 (2013)  
ES 39-87 (2015)

140'-0.410 g/t Au  
incl. 20'-1.17 g/t Au

20'-52.2 g/t Ag

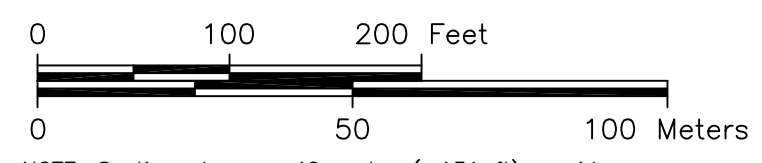

NOTE: Sections have a 40 meter (~131 ft) corridor

**CORDEX EXPLORATION CO.**  
**Eastside Project**  
T4N-R39E, M.D.B.&M.  
Esmeralda County, Nevada

**Section 9180N**

Drawn By: J.A.T. Drawing: 255-ES-XS-2015-NAD83.dwg Layout: XS-100sc-AssaysOnly NOTE: Datum NAD83Z11	Date: Sept. 19, 2015 Revised:
--	----------------------------------

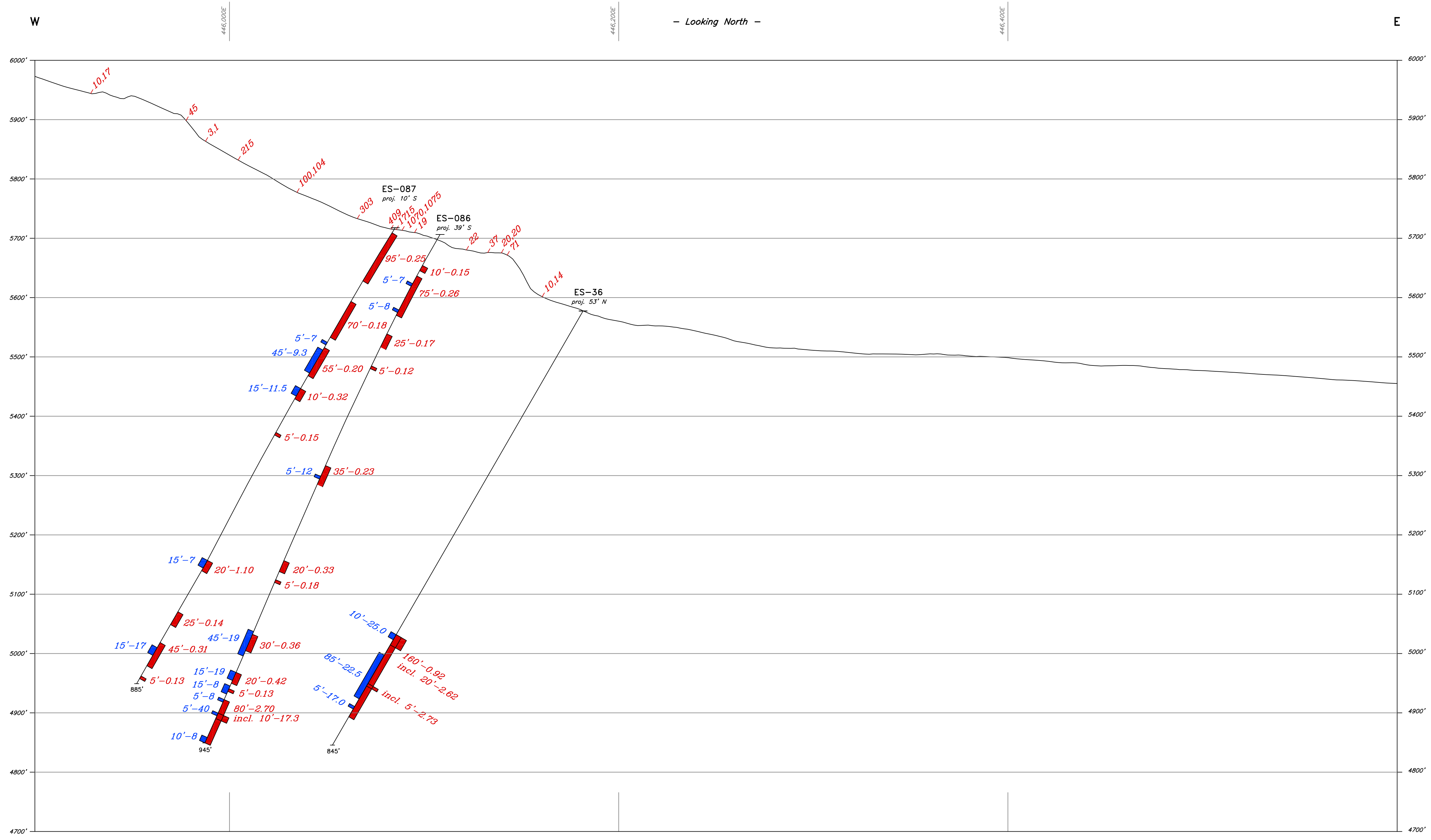

-1070.1075

Surface Sample in Au ppb: comma designates multiple samples taken at same location. Staggered values designate samples taken at separate locations but running along the same Northing

Cordex Drill Hole  
 ES 1-12 (2011), ES 13-36 (2013)  
 ES 39-87 (2015)

140'-0.410 g/t Au  
 incl. 20'-1.17 g/t Au

20'-52.2 g/t Ag

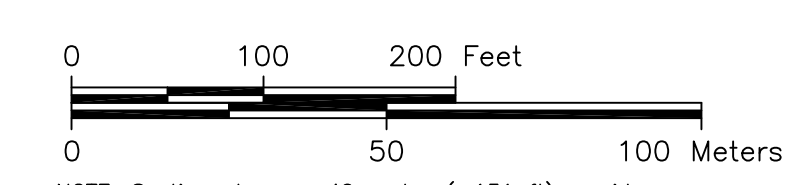

NOTE: Sections have a 40 meter (~131 ft) corridor

**CORDEX EXPLORATION CO.**

**Eastside Project**

T4N-R39E, M.D.B.&M.  
Esmeralda County, Nevada

**Section 9340N**

Drawn By: J.A.T. Drawing: 255-ES-XS-2015-NAD83.dwg Layout: XS-100c-AssaysOnly NOTE: Datum NAD83Z11	Date: Sept. 19, 2015 Revised:
---	----------------------------------



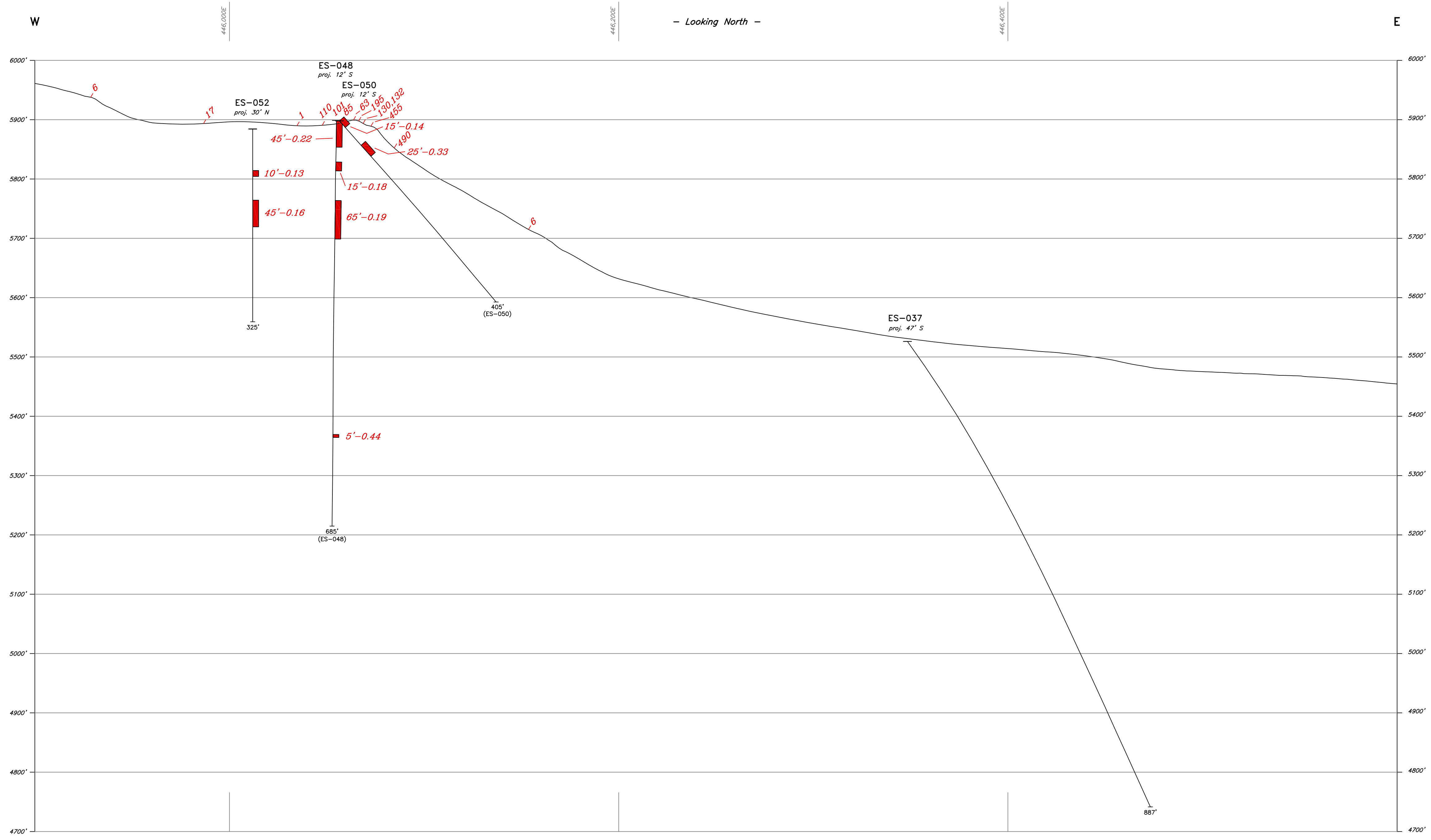

-1070.1076

Surface Sample in Au ppb: comma designates multiple samples taken at same location, Staggered values designate samples taken at separate locations but running along the same Northing

Cordex Drill Hole  
ES 1-12 (2011), ES 13-36 (2013)  
ES 39-87 (2015)

140'-0.410 g/t Au  
incl. 20'-1.17 g/t Au

20'-52.2 g/t Ag

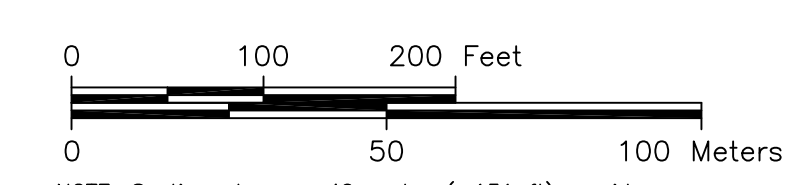

NOTE: Sections have a 40 meter (~131 ft) corridor

<i>CORDEX EXPLORATION CO.</i>	
<b>Eastside Project</b>	
T4N-R39E, M.D.B.&M. Esmeralda County, Nevada	
<b>Section 9460N</b>	
Drawn By: J.A.T. Drawing: 255-ES-XS-2015-NAD83.dwg Layout: XS-100cc-AssaysOnly NOTE: Datum NAD83Z11	Date: Sept. 19, 2015 Revised:

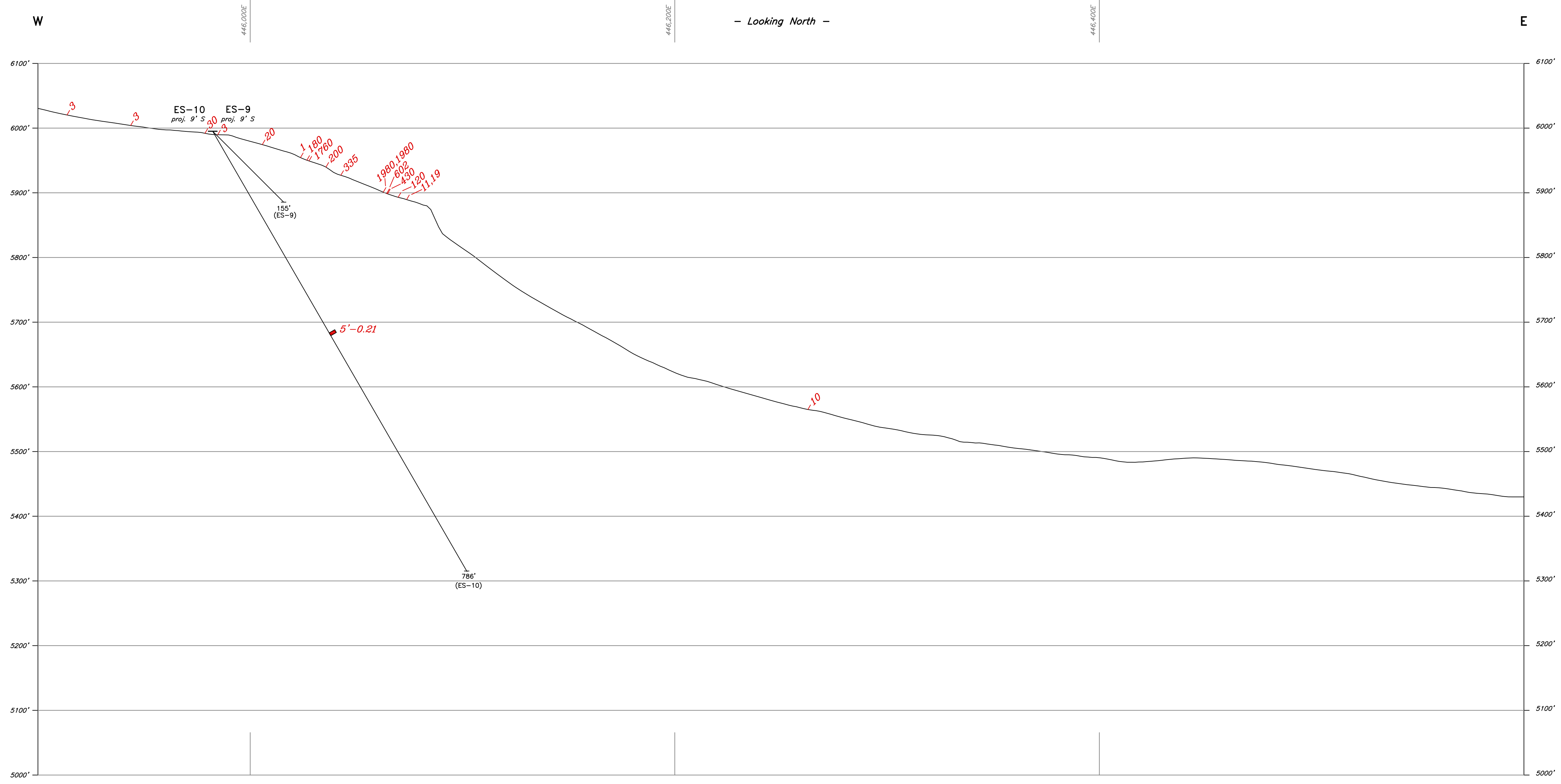

-1070,1075

Surface Sample in Au ppb: comma designates multiple samples taken at same location, Staggered values designate samples taken at separate locations but running along the same Northing

Cordex Drill Hole  
ES 1-12 (2011), ES 13-36 (2013)  
ES 39-87 (2015)

140'-0.410 g/t Au  
incl. 20'-1.17 g/t Au

20'-52.2 g/t Ag

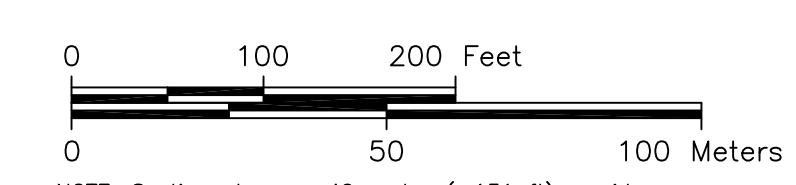

NOTE: Sections have a 40 meter (~131 ft) corridor

*CORDEX EXPLORATION CO.*

**Eastside Project**

T4N-R39E, M.D.B.&M.  
Esmeralda County, Nevada

**Section 9540N**

Drawn By: J.A.T. Drawing: 255-ES-XS-2015-NAD83.dwg Layout: XS-100cc-AssaysOnly NOTE: Datum NAD83Z11	Date: Sept. 19, 2015 Revised:
--	----------------------------------